

EDM-22E Control Box

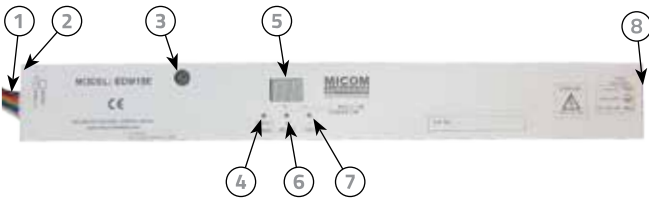

No:	Description
1. EMICON	Connection of EMICON Harness to Control by Plug in
2. Motor	Connection of Motor to Control by Plug in
3. Buzzer	Audible indication of error status or other applications
4. Enter Prog.	Hold to enter programme mode
5. LED Display	LED Display is a visual display for the installer to correctly set up and operate EDM-E Operator. LED Display: – LED1 – Function/Application – LED2 – Parameter Value – POWER LED – Power Indicator – INPUT LED – Signal Input Indicator
6. + Reset	*/ Operational settings – value can be increased. Reset Button – Operation factory settings can be restored.
7. Test	*/ Operational settings – value can be decreased. Test Button – Used to check the basic function of the operator when servicing or installation. Activation signal for Test open cycle.
8. Power	Input 200–240V AC 3pin Plug in

EDM-22E Motor Gear Box

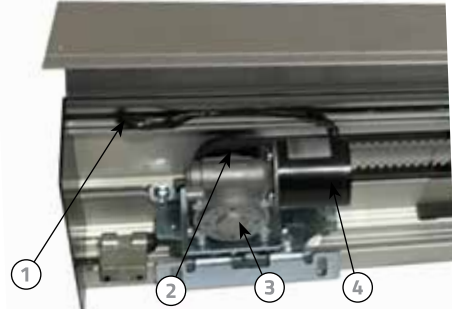

No:	Description
1.	Connection Harness to Control Box
2.	Motor Pulley
3.	Motor Mount Base with Vibration Proof Rubber
4.	NEW Compact Brushless DC Motor

Delivery

MICOM EDM-22E-VSLIM – Supplied in formats as follows:

- EDM ‘COMPLETE OPERATOR’ consisting of: Base Rail, Cover, Control Box, EMICON Board, Motor Gear Box, End Covers, Tooth Belt, Belt Bracket Link Assembly, Belt Connection Single & Double Door, Idle Pulley Assembly, Hanger Roller Brackets x4 and Stopper x3.
- COMPLETE OPERATOR – Standard Rail Length: Single Leaf – up to 3000mm, Double leaf – up to 6000mm
- Available with Mounting Profile. See drawing as shown below. Stock length up to 6000mm

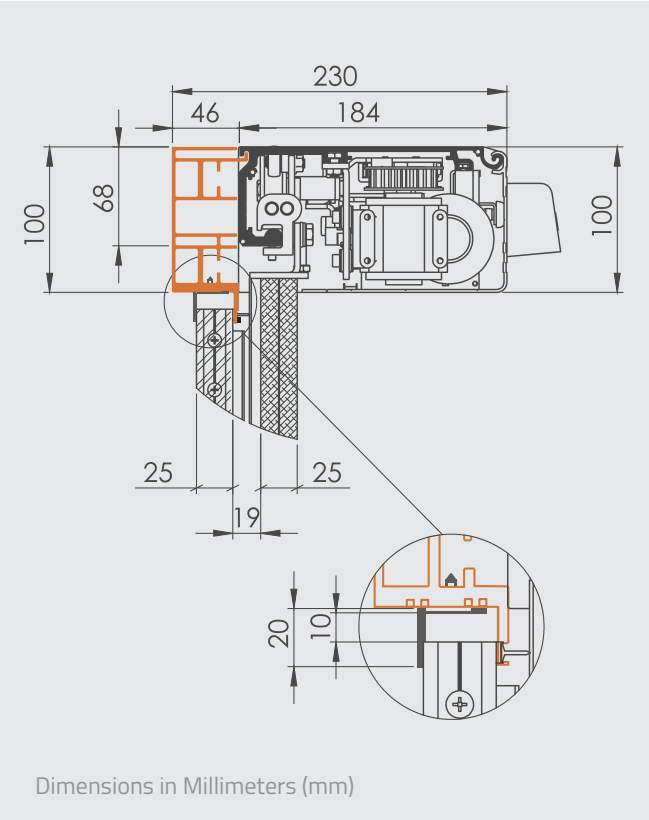

Specification

Model	22E-VSLIM-S	22E-VSLIM-D
Application	Single	Double
Door Weight (max)	160kg	110kg x2
Power Consumption	100 - 240V AC / 50 - 60 Hz - 2A	
Power Output	24V DC, 300mA (for accessory only)	
Control System	Microprocessor	
Motor	Encloses Brushless DC Motor	
E-Lock	Electromagnetic Lock – Fail Secure Lk1/FailSafe Lk2 (optional)	
Battery	Allows open or closing in an emergency situation or when power fails	
Open Door Speed	Adjustable 70 - 820mm/s (adjustable)	
Close Door Speed	Adjustable 70 - 400mm/s (adjustable)	
Open Door Timer	0 - 60sec (10 steps adjustable)	
Partial Open	5 - 90% (10 steps adjustable)	
Safety Obstruction	Detects when opening/closing by Safety Return/Safety Stop	
Pressure - Door to Frame	A small force may be adjusted in order to keep the door closed or open. Force from 0 to 8kg (5 step adjustable)	
Opening safety levels C and D – EN16005 for emergency exits	Redundant detection of security elements for activation of door opening in an emergency	
Operating Temperature & Humidity	Ambient temperate 0°C - 50°C (no consideration or icing). Ambient humidity 30% - 85% (environment must be free of hazardous materials)	



UK / European Office
The Grainger Suite // Regent Centre // Gosforth
Newcastle upon Tyne // NE3 3PF // United Kingdom

Telephone. +44 (0)191 233 6323
Email. info@micomautodoor.com

Head Office - Japan
6th Floor // Marutake-Honmachi Building 6-18
Honmachi 1-Chome Chuo-ku // Osaka 541-0053 // Japan

Telephone. +81 6 6265 1130
Facsimile. +81 6 6265 1132
Email. info@micomautodoor.com



Introduction

EDM-22E-VSLIM is the perfect choice for all automatic sliding pedestrian doors. Its very compact and aesthetic housing design will compliment any installation project. 22E-VSLIM is a durable and high-quality automatic sliding door operator system.

With increased power, 22E-VSLIM offers faster opening acceleration, a higher door opening speed and an overall increased weight capacity. Utilising our advanced microprocessor control unit with increased power and our NEW compact brushless motor, we achieve near silent and smooth motion of 820mm/s up to 160kg per leaf. New electronics guarantee a higher level of security appropriate to the new requirements dictated by the EN 16005 for all EU emergency exits.

Installation is simple and achieved in several steps. Starting with a one-time learning cycle of the door stroke and offering variable function adjustment for single or double door leaves. Operational parameters can be adjusted to suit individual installations, through the easily accessible LED visual display found on 22E-VSLIM Control box face.

Designed specifically to meet the highest demands of the European market, 22E-VSLIM is CE, TUV and EN16005 compliant. Offering a host of features and benefits, 22E-VSLIM will provide you with assured safe and long term service.

Main Features

- > Suitable for emergency exits (EN16005)
- > Power input 100-240VAC (50/60Hz)
- > Door Capacity 160kg x1 / 110kg x2
- > Door Open Speed 820mm/s max
- > Memorized one time door stroke
- > Easily accessible sensor and threshold safety Inputs
- > 24V DC Power Output for All Accessories
- > LED Digital Control Display
- > Wide Parameter Adjustments
- > Door Speed & Braking Adjustment
- > Energy Saving (% Open) Function
- > Emergency Stop (Open or Close)
- > Ratchet or Flip-Flop Function
- > Battery Open/Close with Monitor as standard
- > Electromagnetic Lock (Fail Safe/Secure) Option
- > Safe & Long Term Operation Guaranteed
- > Selector Switch supplied as standard

EMICON Communicator - Quick and Easy Connections to Accessories and Ancillaries

Our **EMICON** interface board offers a quick means of installation. Communication of all accessory and safety signals are combined with battery input and lock control. Working in parallel, these signals are controlled via our Selector Switch for greater ease of operation by the end user.

MICOM Rotary Key Selector Switch is supplied as standard together with EDM-E Series operator allowing selection of 4 separate door modes. In a fire retardant black plastic mount box with cover design in white, MICOM function selectors can be fitted to walls or aluminium frames alike.

Functions:

- > Lock – Night/Closed
- > Exit Only
- > Automatic
- > Hold Open



The **EMICON** communicator interconnects the Control Unit with the different peripheral components as follows:

No:	Description
1.	24V Output 0.3A max
2.	Monitoring Input
3.	Emergency Stop Input
4.	Emergency Open/Close Input
5.	Night Switch
6.	E-Lock Output
7.	Internal Sensor with 24V Output

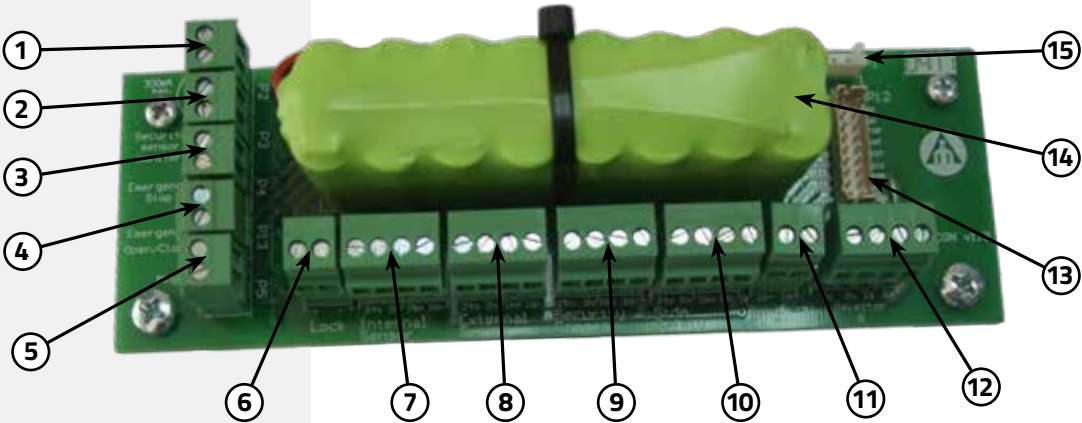

No:	Description
8.	External Sensor with 24V Output
9.	Safety Beam Sensor with 24V Output
10.	Side Screen Sensor with 24V Output
11.	Selector A
12.	Selector B
13.	Control Unit Connector
14.	Battery
15.	Battery Connector

EDM-22E-VSLIM when used without monitoring can also accept all current sensors available in the world market today, such as BEA Eagle & Optex OA-203C together with threshold safety beam protection.

EAGLE Series is a microwave sensor which detects movement. Utilising a planar antenna together with multi directional detection modes, the EAGLE offers high levels of stability and reliability. It is the solution for all types of automatic doors, irrespective of the surroundings utilizing K-band microwave technology.



OS-12C Safety Beam is an active infrared safety beam system. Its amplifier and sensor heads are designed for fast, simple installation while maintaining the highest standards of safety and reliability. Recognized by door professionals worldwide for its reliability and resistance to sunlight and other interference.



Accessories

Accessories

MICOM Digital Selector Switch offers further options of door control. A digital touchpad, allows selection of 6 separate door modes. Economic in design, MICOM Digital Selectors are easy to install and operate. Supplied in a fire retardant black plastic mount box, with attractive cover design in white, our function selectors can be fitted to walls or aluminium frames alike.

Functions:

- > Lock – Night/Closed
- > Exit Only
- > Entry Only
- > Automatic
- > Hold Open
- > Half Open



Door Profile Solutions - Various Fixed and Moving profile designs available without glass.

Glass Fittings

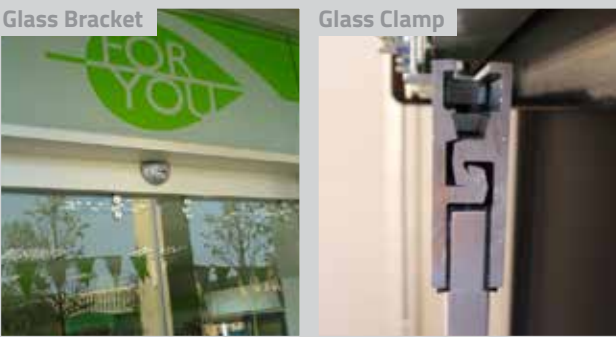

Glass Bracket - For 10mm glass door 90kg max / 1.2m width max & 12mm glass door 120kg max / 1.5m width max
Glass Clamp - For 10mm glass door 100kg max / 1.5m width max

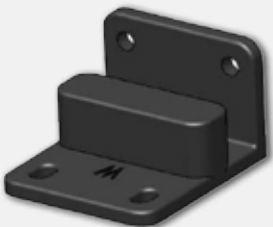

Floor Guide - Floor guides for framed and frameless glass doors available.

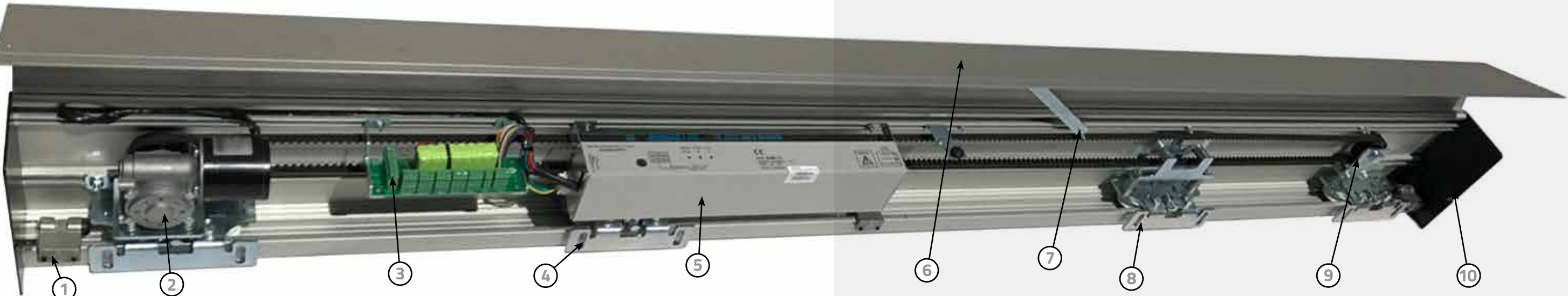

Product Summary

No:	Description
1.	End Stopper
2.	NEW Compact Motor Gear Box with Vibration Rubber
3.	EMICOM Board with Battery
4.	Hanger Roller Bracket Single Door (with Belt Link)
5.	Control Box with Fixing Plate
6.	Cover (Interlocking Hinge)
7.	Cover Support for Maintenance
8.	Hanger Roller Bracket Double Door (with Belt Link)
9.	Idle Pulley
10.	End Cover

EDM-E Series

EDM-18E



EDM-18E-VSLIM-2S/D



EDM-30E



EDM-18E-RD



EDM-22E-VSLIM complies with all new EU regulations (EN16005) for enhanced automatic door safety. Designed for use with a new range of sensors such as BEA IXIO-S & Optex OA-Axis-T.

IXIO-S is an active infrared presence sensor. The tridimensional area of its infrared curtain protects the users from any contact with the doors. Adjustment is made easier with an LCD screen offering 10 different widths of curtains, to cover the full travel area of the door.



OA-AXIS-T Series based on active infrared technology. Developed as a combination sensor for threshold safety and activation, the OA-Axis T is in compliance with the latest European and local regulations as EN 16005 and DIN 18650, tested and approved by the German test organisation TÜV. Due to its variety in output options the OA-Axis series meets the requirements in various markets throughout Europe.

